

JAFTEX

EST. 1930

Free Spirit

Henry Glass & Co., Inc.

STUDIO fabrics
A Division Of JafTex Corporation
www.studiofabrics.net

Blank
QUILTING CORPORATION
the fabric of inspiration

3wishes
fabric

A.E. NATHAN COMPANY, INC.

Fabric
Editions, Inc.

Learn. Make. Love.

SIY Project



Sew It Yourself

The following project was created with fabric that your local retailer may no longer have available. You can re-create these projects by replacing the fabrics shown using the fabric key as a guide for similar colorations or styles.

PROJECT DISCLAIMER: Every effort has been made to ensure that all projects are error free. All the information is presented in good faith, however no warranty can be given not results guaranteed as we have no control over the execution of instructions. Therefore, we assume no responsibility for the use of this information or damages that may occur as a result. When errors are brought to our attention, we make every effort to correct and post a revision as soon as possible. We recommend that you test the project prior to cutting for kits. Finally, all free projects are intended to remain free to you and are not for resale.

SIY - Sew It Yourself™ is a trademark of JafTex Corporation



Tree Skirt

JOYFUL TIDINGS

by Emma Leach

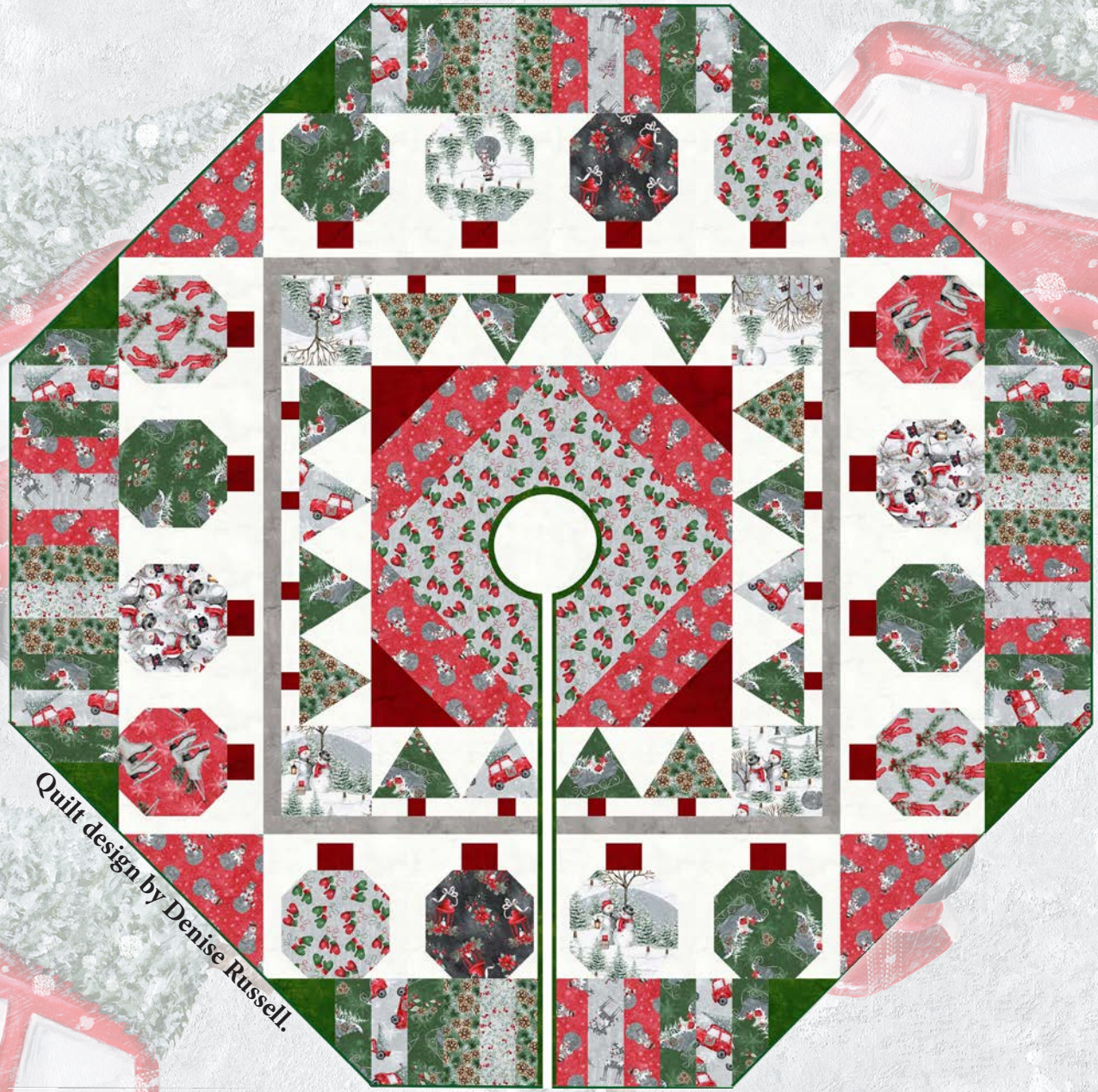

Quilt design by Denise Russell.

Size: 60" x 60." Skill Level: Intermediate.

Blank Quilting Corporation
49 West 37th Street ♦ New York, NY 10018
Tel: 800-294-9495 ♦ Fax: 212-679-4578
www.blankquilting.net



Free Project
NOT FOR RESALE

JOYFUL TIDINGS - Fabrics in the Collection



1561-90 Christmas Stockings
Lt. Gray



1562-88 Ice Skates
Red



1563-99 Lanterns with
Poinsettia - Black

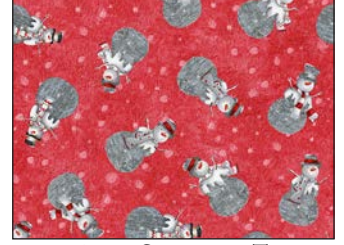

1564-88 Snowman Toss
Red



1565-90 Mittens
Lt. Gray



1566-66 Pine Cones
Green



1567-66 Snowy Pine Trees
Green



1568-90 Tossed Reindeer with
Christmas Trees - Lt. Gray

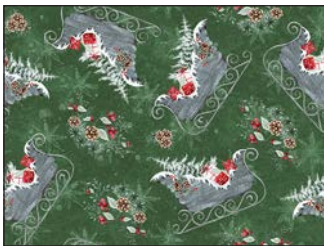

1569-66 Christmas Sleighs
Green



1570-90 Snowman Collage
Lt. Gray



1571-01 Scenic Snowman
White



1572-90 Christmas Berries
Lt. Gray



1573-90 Christmas Cars with
Trees - Lt. Gray

Selected fabric from the Urban Legend collection
by Tana Mueller

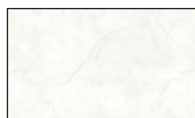

7101-01 Ivory

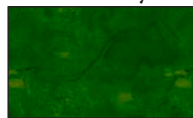

7101-66 Hunter



7101-88 Red



7101-90 Gray

Materials

Yardages and cutting instructions are based on 42" of usable fabric width.

1/8 yard 1568-90 Tossed Reindeer with Christmas Trees - Lt. Gray
1/8 yard 1572-90 Christmas Berries – Lt. Gray
1/4 yard 1561-90 Christmas Stockings - Lt. Gray
1/4 yard 1562-88 Ice Skates - Red
1/4 yard 1563-99 Lanterns with Poinsettia - Black
1/4 yard 1570-90 Snowman Collage - Lt. Gray
1/4 yard 1571-01 Scenic Snowman - White
1/4 yard 7101-90 Urban Legend - Gray
1/3 yard 7101-88 Urban Legend - Red
3/8 yard 1565-90 Mittens - Lt. Gray
3/8 yard 1566-66 Pine Cones - Green
3/8 yard 1573-90 Christmas Cars with Trees - Lt. Gray
5/8 yard 1564-88 Snowman Toss - Red
3/4 yard 1569-66 Christmas Sleighs - Green
1-1/8 yards 7101-66 Urban Legend - Hunter
1-1/4 yards 7101-01 Urban Legend - White
3-7/8 yards 1568-90 Tossed Reindeer with Christmas Trees - Lt. Gray
68" x 68" piece of Air Lite® Colour Me 100% Cotton batting
Paper for foundation piecing
6 10" lengths of ribbon (optional)

Cut Fabrics

Note: *All strips are cut across the width of the fabric (WOF) from selvage to selvage unless otherwise indicated.*

From each, cut:

1568-90 Tossed Reindeer with Christmas Trees - Lt. Gray

1572-90 Christmas Berries – Lt. Gray

*One 2-1/2" x WOF strip.

From each, cut:

1561-90 Christmas Stockings - Lt. Gray

1562-88 Ice Skates – Red

1563-99 Lanterns with Poinsettia – Black

1570-90 Snowman Collage - Lt. Gray

*One 6-1/2" x WOF strip. Sub-cut two 6-1/2" squares.

From 1571-01 Scenic Snowman – White, cut:

*One 6-1/2" x WOF strip. Sub-cut two 6-1/2" squares and four 5-1/2" squares.

From 7101-90 Urban Legend – Gray, cut:

*Four 1-1/2" x WOF strips for border 2.

From 7101-88 Urban Legend – Red, cut:

*One 2" x WOF strip. Sub-cut sixteen 2" x 2-1/2" strips.

*One 6" x WOF strip. Sub-cut:

- Four 6" squares.

- Sixteen 2" squares (Section B2).

From 1565-90 Mittens - Lt. Gray, cut:

*One 10-7/8" x WOF strip. Sub-cut two 10-7/8" squares and two 6-1/2" squares.

From each, cut:

1566-66 Pine Cones – Green

1573-90 Christmas Cars with Trees - Lt. Gray

*Two 2-1/2" x WOF strips.

*One 5-3/4" x WOF strip. Sub-cut four 5-3/4" squares (Section A1).

From 1564-88 Snowman Toss – Red, cut:

*Two 2-1/2" x WOF strips.

*One 12-5/8" x WOF strip. Sub-cut:

- One 12-5/8" square; cut diagonally twice. (W)

- Two 10-7/8" squares.

From 1569-66 Christmas Sleighs – Green, cut:

*Four 2-1/2" x WOF strips.

*One 5-3/4" x WOF strip. Sub-cut seven 5-3/4" squares (Section A1).

*One 6-1/2" x WOF strip. Sub-cut four 6-1/2" squares and one 5-3/4" squares (for a total of eight Sections A1).

From 7101-66 Urban Legend – Hunter, cut:

*One 6" x WOF strip. Sub-cut eight 5" x 6" rectangles.

*Nine 2-1/2" x WOF strips for binding.

*Two 2-1/2" x 12" bias strips from a corner of the leftover fabric for circle binding.

From 7101-01 Urban Legend – White, cut:

*One 1-1/2" x WOF strip. Sub-cut six 1-1/2" x 6-1/2" strips.

*Three 2" x WOF strips. Sub-cut sixty-four 2" squares.

*Three 3" x WOF strips. Sub-cut:

- Thirty-two 2" x 3" strips (Sections B1, B3).

- Four 3" x 6" rectangles (Sections A2, A3).

- Sixteen 1" x 2-1/2" strips.

*Two 3-1/2" x WOF strips. Sub-cut thirty-two 2-1/2" x 3-1/2" rectangles.

*Two 6" x WOF strips. Sub-cut twenty-eight 3" x 6" rectangles (for a total of thirty-two Sections A2, A3).

*One 6-1/2" x WOF strip. Sub-cut twenty-six 1-1/2" x 6-1/2" strips (for a total of thirty-two).

Assemble Blocks

Measurements include 1/4" seam allowances. Sew with right sides together unless otherwise stated. If no direction is specified, press the seam toward the darker fabric.

1. Draw a diagonal line on the wrong side of the 10-7/8" 1565-90 Mittens - Lt. Gray squares. With right sides together, layer the marked Mittens squares atop the 10-7/8" 1564-88 Snowman Toss - Red squares. Stitch 1/4" on each side of the marked line and cut on the drawn line. Press each unit open with seams toward dark fabric and trim dog ears. Make four 10-1/2" half-square triangles (HST). Noting fabric orientation, sew the HST together to make the 20-1/2" center block, and press the seams in one direction.

Draw a diagonal line on the wrong side of the 6" 7101-88 Urban Legend - Red squares. With right sides together, place one marked Red square on a corner of the center block and stitch on the drawn line. Repeat with the other corners of the square, trim the seam allowances to 1/4" and press open (*figure 1*).

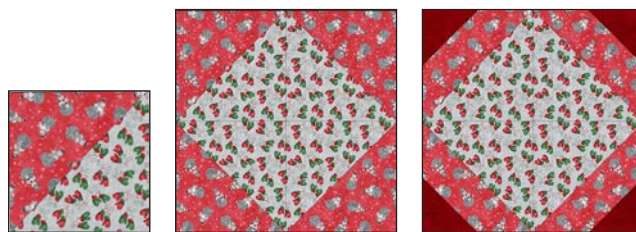
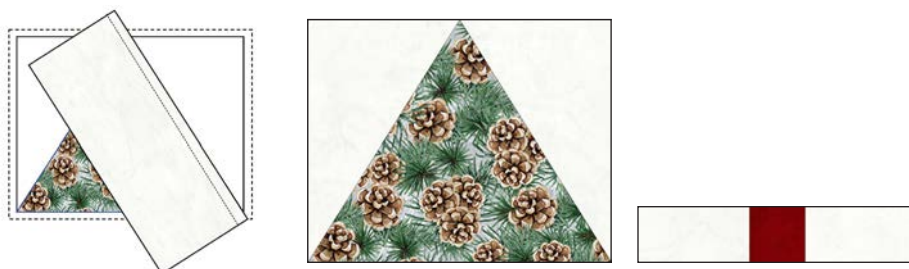

Figure 1 – Make (1) 20-1/2" block.

2. Trace or print sixteen copies of templates A and B. Paper piece each section referring to Table 1 on the next page for fabric placement, noting that you will place the fabrics on the backside of the templates and will stitch the seams on the printed side of the templates. Press open, trim, and remove the paper.



	Section	Number of pieces required and Fabric Description
Template A	A1	(4) 5-3/4" squares 1566-66 Pine Cones - Green (4) 5-3/4" squares 1573-90 Christmas Cars with Trees - Lt. Gray (8) 5-3/4" squares 1569-66 Christmas Sleighs – Green
	A2	(16) 3" x 6" rectangles 7101-01Urban Legend – White
	A3	(16) 3" x 6" rectangles 7101-01Urban Legend - White
Template B	B1	(16) 2" x 3" strips 7101-01Urban Legend – White
	B2	(16) 2" squares 7101-88 Urban Legend - Red
	B3	(16) 2" x 3" strips 7101-01Urban Legend – White

Table 1. Fabric placement for paper piecing.

Sew one template B to the bottom of each template A to make sixteen 5-1/2" tree blocks (*figure 2*). Press the seams toward the trees.

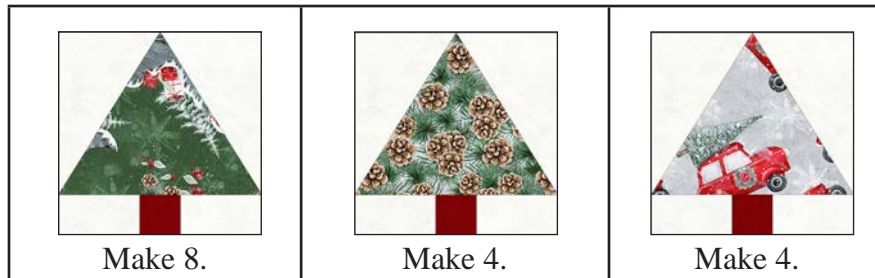

Figure 2 – Make (16) assorted 5-1/2" tree blocks.

3. Draw a diagonal line on the wrong side of the 2" 7101-01Urban Legend – White squares. With right sides together, place one marked White square on a corner of one 6-1/2" 1561-90 Christmas Stockings – Lt. Gray square and stitch on the drawn line. Repeat with the other corners of the square, trim seam allowances to 1/4" and press open (*figure 3*). Make two units. Repeat with the 6-1/2" 1562-88 Ice Skates – Red, 1563-99 Lanterns with Poinsettia – Black, 1570-90 Snowman Collage - Lt. Gray, 1571-01 Scenic Snowman – White, 1569-66 Christmas Sleighs – Green, and 1565-90 Mittens - Lt. Gray to make sixteen 6-1/2" units.



Figure 3 – Make (16) 6-1/2" units of assorted fabrics.

4. Sew two 1-1/2" x 6-1/2" 7101-01Urban Legend – White strips to opposite sides of the Step 3 units (*figure 4*). Press the seams away from the center.



Figure 4

5. Sew a 1" x 2" 7101-01 Urban Legend – White strip to each 2" x 2-1/2" 7101-88 Urban Legend – Red strip. Press the seam toward the White strip. Repeat to make sixteen units. Sew two 2" x 3-1/2" 7101-01 Urban Legend – White strips to opposite sides of the Red/White units. Press the seams away from the center. Sew each unit to the top of the Step 4 units to make sixteen 8-1/2" ornament blocks (*figure 5*).



Figure 5 – Make (16) assorted 8-1/2" ornament blocks.

6. Sew a 2-1/2" 1573-90 Christmas Cars with Trees - Lt. Gray strip in between two 2-1/2" 1569-66 Christmas Sleighs – Green strips to make a strip set. Repeat to make another set. Press the seams in one direction. Cross-cut the strip sets into eight 6-1/2" sections.

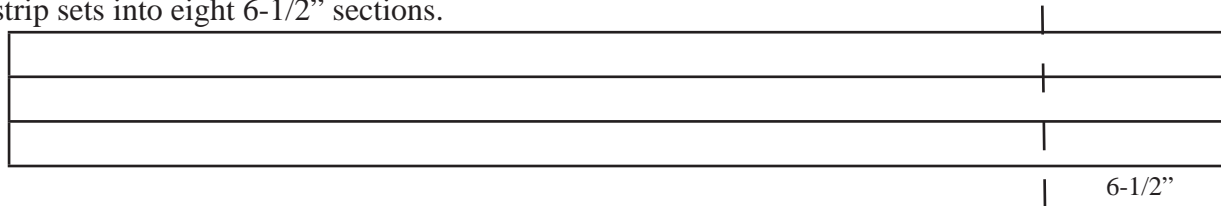

Repeat this step with the 2-1/2" 1572-90 Christmas Berries – Lt. Gray and the two 2-1/2" 1566-66 Pine Cones – Green to make one strip set, and the 2-1/2" 1568-90 Tossed Reindeer with Christmas Trees – Lt. Gray and two 2-1/2" 1564-88 Snowman Toss – Red strips to make the last strip set. Cross-cut these sets into four 6-1/2" sections each (*figure 6*).



Figure 6 – Make (16) assorted 6-1/2" units.

Assemble Quilt Top

7. For border 1 and referring to the quilt photo for block placement and orientation, arrange four tree blocks for each side of the quilt. Sew blocks together and sew one border strip to each side of the quilt center. Press the seam toward the quilt center.

8. Repeat Step 7 with the four 5-1/2" 1571-01 Scenic Snowman - White squares and the remaining tree blocks and sew one border strip (two squares and four tree blocks on each strip) to the top and one to the bottom of the quilt center.

9. For border 2, sew the four 1-1/2" 7101-90 Urban Legend - Gray strips together end to end using diagonal seams. Measure the vertical length of the quilt top through the center and cut two border strips that length. Sew one strip to each side of the quilt top. Measure the width of the quilt top through the center. Cut two border strips that length and sew one to the top and one to the bottom. Press the seams toward the borders. The tree skirt measures 32-1/2" x 32-1/2" up to here.

10. For border 3 and referring to the quilt photo for block placement, arrange four ornament blocks for each side of the quilt. Sew blocks together and sew one border strip to each side of the quilt. Press the seams toward the center.

11. Repeat Step 10 with the four 1564-88 Snowman Toss - Red triangles W and the remaining ornament blocks and sew one border strip (two triangles and four ornament blocks on each strip) to the top and one to the bottom of the quilt center.

12. For border 4, make four border strips by sewing together the Step 6 sections in this order: X, Z, Y, X. Sew two 5" x 6" 7101-66 Urban Legend – Hunter rectangles to each end of the strips. Press the seams in one direction. Fold the quilt center in half with right sides together and crease to mark the center. Fold the border strips in half with **wrong** sides together and crease to mark the center. Nest the creased centers, pin, and sew the borders to each side. Press the seams

away from the center.

Align a long acrylic ruler with the edge of a corner of border 3 and trim the end rectangles of border 4. Repeat all around to form the octagon.

Finishing

13. Create a quilt sandwich with the batting between the quilt top and the backing. Pin or baste layers together, mark quilting design, and quilt by hand or machine. When quilting is complete, remove pins or basting, and trim batting and backing even with raw edges of the quilt top.

14. Draw a 4" or 5" circle (the circle size will depend on the diameter of the tree trunk) in the middle of the tree skirt and cut on the outline to remove the center. To cut the tree skirt opening, draw a straight line from the circle at the center of the quilt to the center of one of the edges of border 4. Cut along the drawn line.

15. Join the two 2-1/2" 7101-66 Urban Legend – Hunter bias strips end to end. Fold in half lengthwise and press. Ease the strip around the circle and pin. Sew it to the edges of the circle, fold the binding to the back of the quilt and stitch it in place by hand. Trim the ends of the bias strip even with the opening.

16. Join the nine 2-1/2" 7101-66 Urban Legend – Hunter binding strips together end to end using a diagonal seam to make one long strip. Fold in half lengthwise and press. Sew binding to the edges of the quilt beginning at one corner of the center circle, and making sure the binding extends out about one inch. Miter the corners while stitching around the octagon. Fold binding to the back of the quilt and stitch it in place by hand to finish, turning in the ends of the binding at the circle.

17. Sew three 10" lengths of ribbon to each side of the opening, evenly spaced, to tie the tree skirt, if desired.

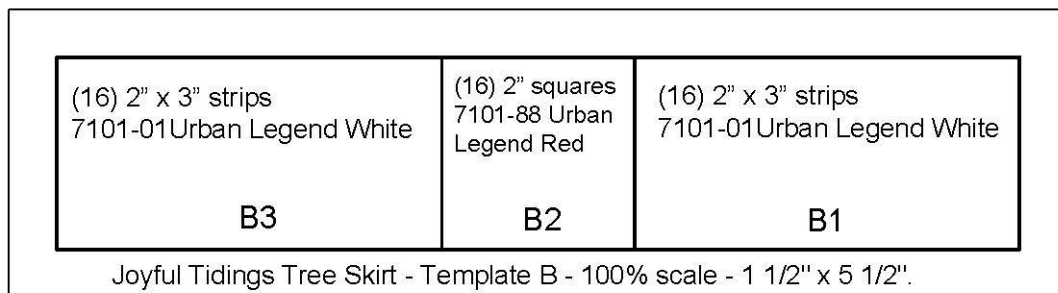
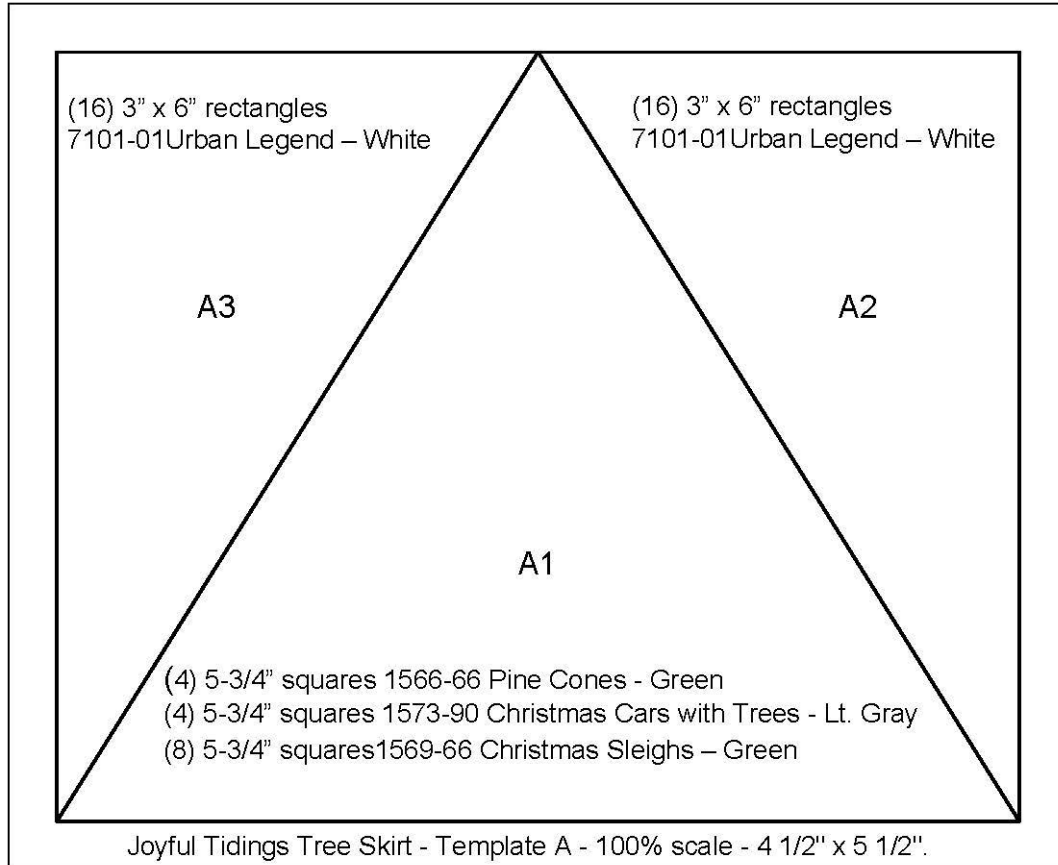
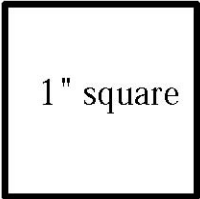

©2020 Blank Quilting Corporation

Every effort has been made to ensure that all projects are error free. All the information is presented in good faith; however, no warranty can be given nor results guaranteed as we have no control over the execution of instructions. Therefore, we assume no responsibility for the use of this information or damages that may occur as a result. When errors are brought to our attention, we make every effort to correct and post a revision as soon as possible. Please make sure to check www.blankquilting.net for pattern updates prior to starting the project. We also recommend that you test the project prior to cutting for kits. Finally, all free projects are intended to remain free to you and are not for resale.